



For Lease

Place Fleurimont

1635-1645 King E., Sherbrooke, QC
Prime Opportunity for Retail



**For more information,
please contact:**

Manon Larose*
+1 438 990 8968
manon.larose@am.jll.com

Michelle Marcotte-Blart**
+1 514 972 6163
michelle.marcotte@am.jll.com

*Chartered real estate broker, DA ** Commercial real estate broker

jll.ca

Overview

Located along a main boulevard in the heart of Sherbrooke. This space is surrounded by well-known retailers including **Dollarama**, **Domino's Pizza**, **Super C**, **Tim Hortons** and many more. This 58,657 square foot space is divisible and offers a large parking lot.



PROPERTY DETAILS

SQUARE FOOTAGE Ground Floor: 58,657 SF (divisible)
ADDRESS 1635-1645 King E. Sherbrooke, QC
AVAILABILITY October 1, 2022
BASIC RENT Contact listing brokers
ADDITIONAL RENT (2022) \$6.59 psf

PROJECT HIGHLIGHTS



Many parking spaces available



Surrounded by many retailers

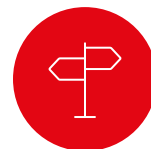







Along a main boulevard

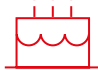

9,163 vehicles per day
1,829 pedestrians per day
(Pinpoint, 2020)

Area Demographics

Source: Statistics Canada, 2021

	5KM	10KM	15KM
 Total Population	73,845	130,987	172,909
 Daytime Population	74,228	141,920	174,160
 Median Age	40.4	42.1	41.4
 Total Households	35,255	61,650	78,319
 Average HH Income	\$67,871	\$75,657	\$81,008
 Total Expenditure (Per Household)	\$62,759	\$70,318	\$76,523

Floorplan

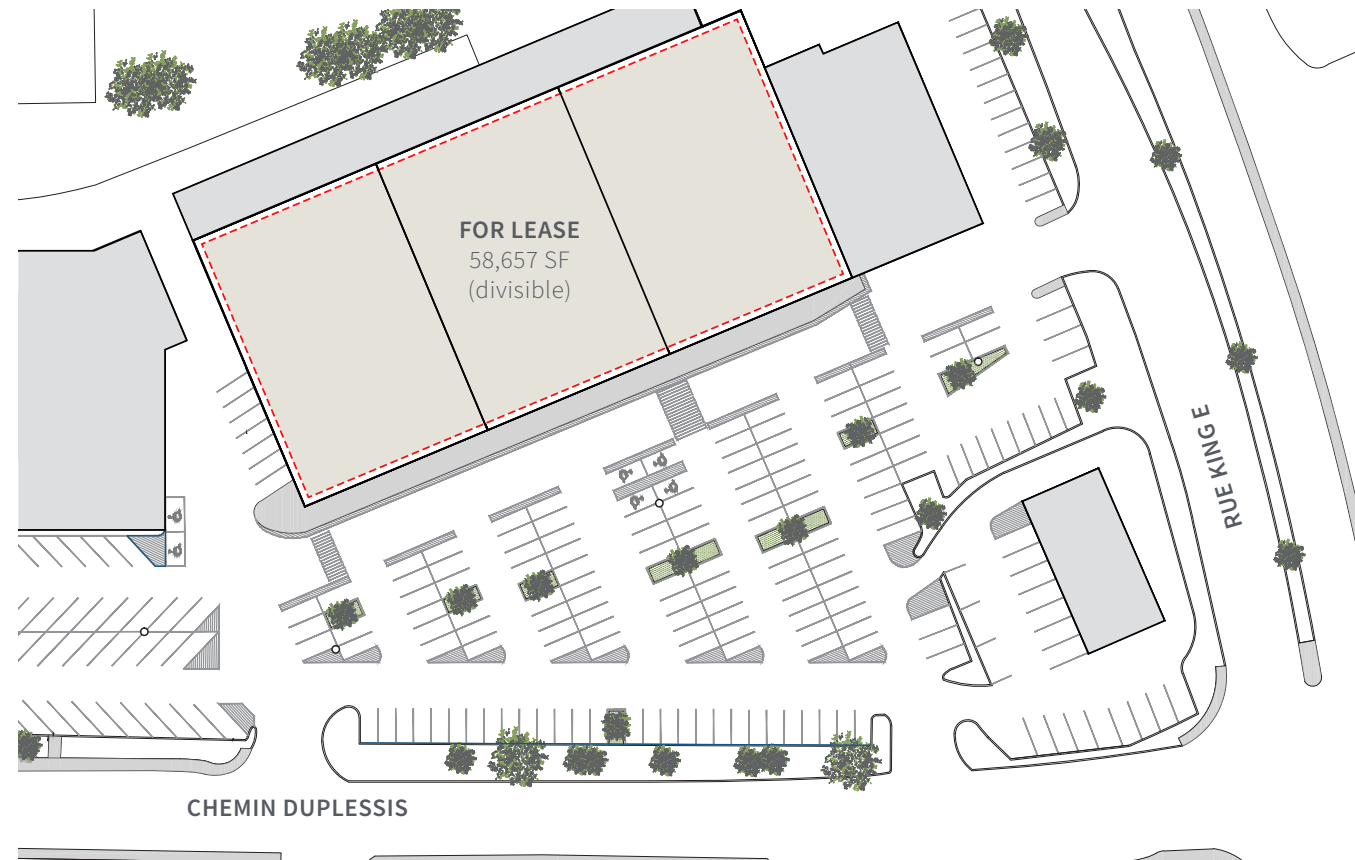

AVAILABLE SUITES

UNIT	SF
Unit 1	58,657 SF (divisible)



Nearby Area

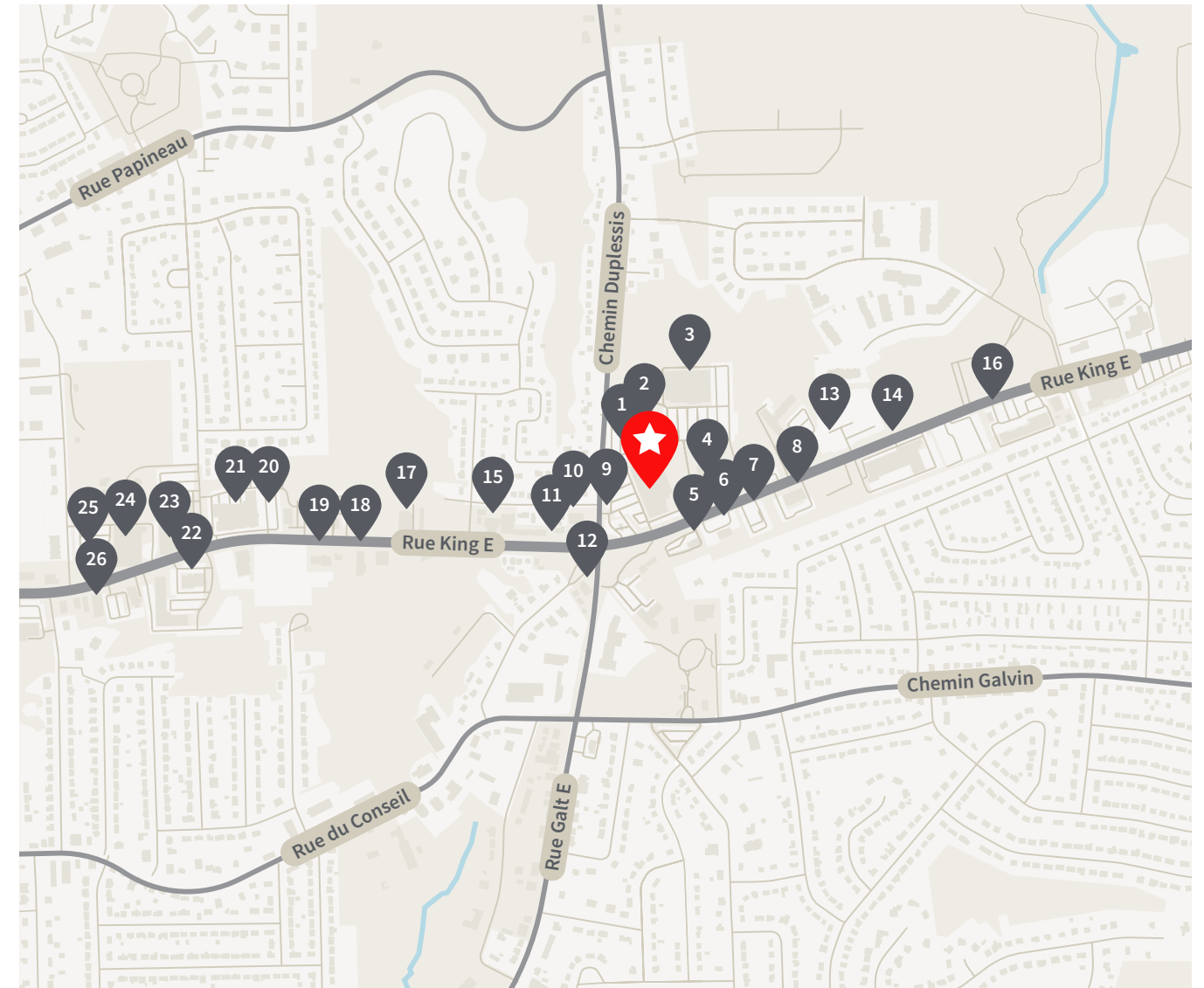

- | | | |
|--------------------------------------|-----------------------------|------------------------|
| 1. Bar Cafe Le Mondial | 11. Super Relais | 19. Speedy |
| 2. Dollarama | 12. Groupe Pro-Transmission | 20. Le Dauphin |
| 3. Super C | 13. Enterprise Truck Rental | 21. Excellence Fitness |
| 4. Hôpital Vétérinaire de Sherbrooke | 14. Boulangerie Georges Inc | 22. Mondou |
| 5. Tim Hortons | 15. EconoPlus | 23. Coco Frutti |
| 6. Couche-Tard | 16. Subway | 24. Metro Plus Plouffe |
| 7. St-Hubert Express | 17. NAPA | 25. SAQ |
| 8. Uniprix | 18. Long & McQuade | 26. CARQUEST |



For Lease

Place Fleurimont

1635-1645 King E., Sherbrooke, QC



Manon Larose*

Senior Vice President, Retail
+1 438 990 8968
manon.larose@am.jll.com

Michelle Marcotte-Blart**

Sales Associate, Retail
+1 514 972 6163
michelle.marcotte@am.jll.com

Although information has been obtained from sources deemed reliable, neither Owner nor JLL makes any guarantees, warranties or representations, express or implied, as to the completeness or accuracy as to the information contained herein. Any projections, opinions, assumptions or estimates used are for example only. There may be differences between projected and actual results, and those differences may be material. The Property may be withdrawn without notice. Neither Owner nor JLL accepts any liability for any loss or damage suffered by any party resulting from reliance on this information. If the recipient of this information has signed a confidentiality agreement regarding this matter, this information is subject to the terms of that agreement. ©2022 Jones Lang LaSalle IP, Inc. All rights reserved. *Chartered real estate broker, DA ** Commercial real estate broker